

# salon chair footrest

TURN CHAIR TO SHOW UNDER BASE  
& UNSCREW 3 BOLTS BELOW

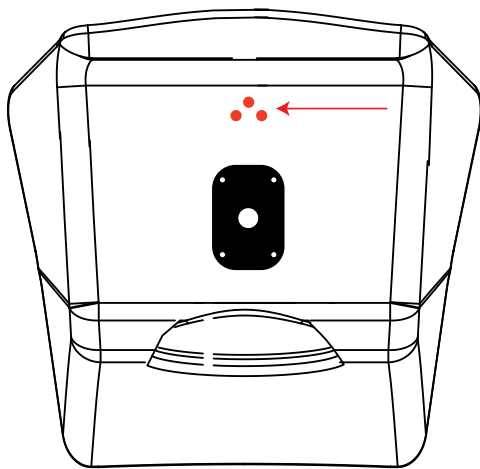

INSTALL FOOTREST WITH 3 BOLTS IN SAME POSITION

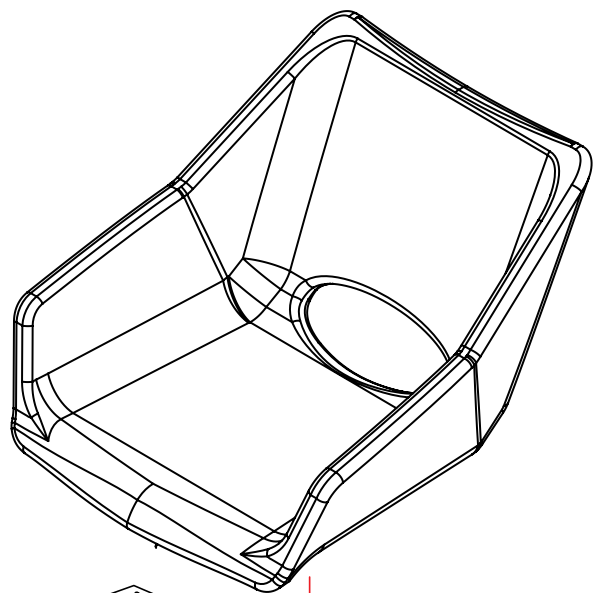

HYDRAULIC LIFT PUMP & BASE ASSEMBLY

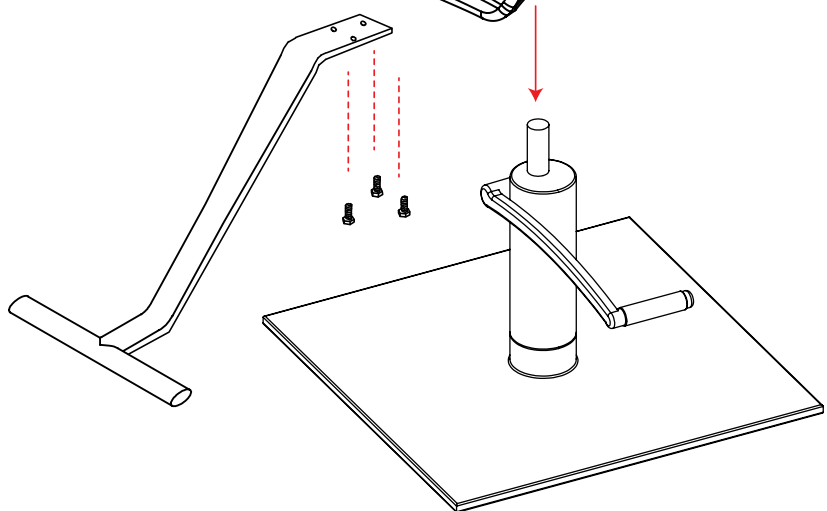
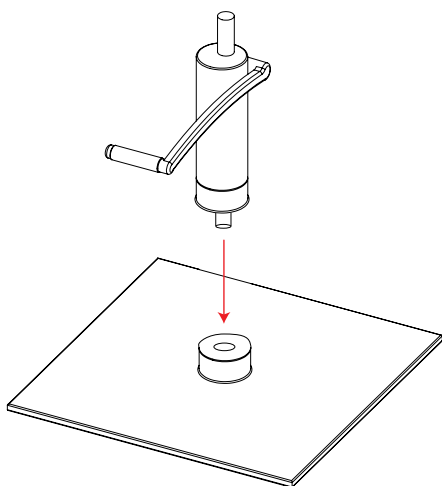

## CLEANING & MAINTENANCE

- Wipe with a clean colourfast cloth dampened with mild alkaline free soap and luke warm water. Do not wet excessively.
- Remove all traces of any cleaning product by wiping with fresh water and a clean cloth.
- Dry with a soft, clean cloth.
- Stubborn grime may require gentle scrubbing with a soft brush.

### Do not use:

- hot or boiling water
- bleach
- silicon or petroleum-based cleaners
- hydrocarbons including alcohol
- steel wool
- acetone
- concentrated detergents
- solvent based or abrasive cleaning agents
- furniture polishes
- abrasive powder or paste cleaner

A periodic inspection of all components and fasteners should be made to ensure that your salon chair is structurally intact and functioning properly.

for more help, tips & solutions go to  
[help.comfortel.com.au](http://help.comfortel.com.au)