

# venus connect

#6032

VENUS CONNECT TREATMENT TABLE

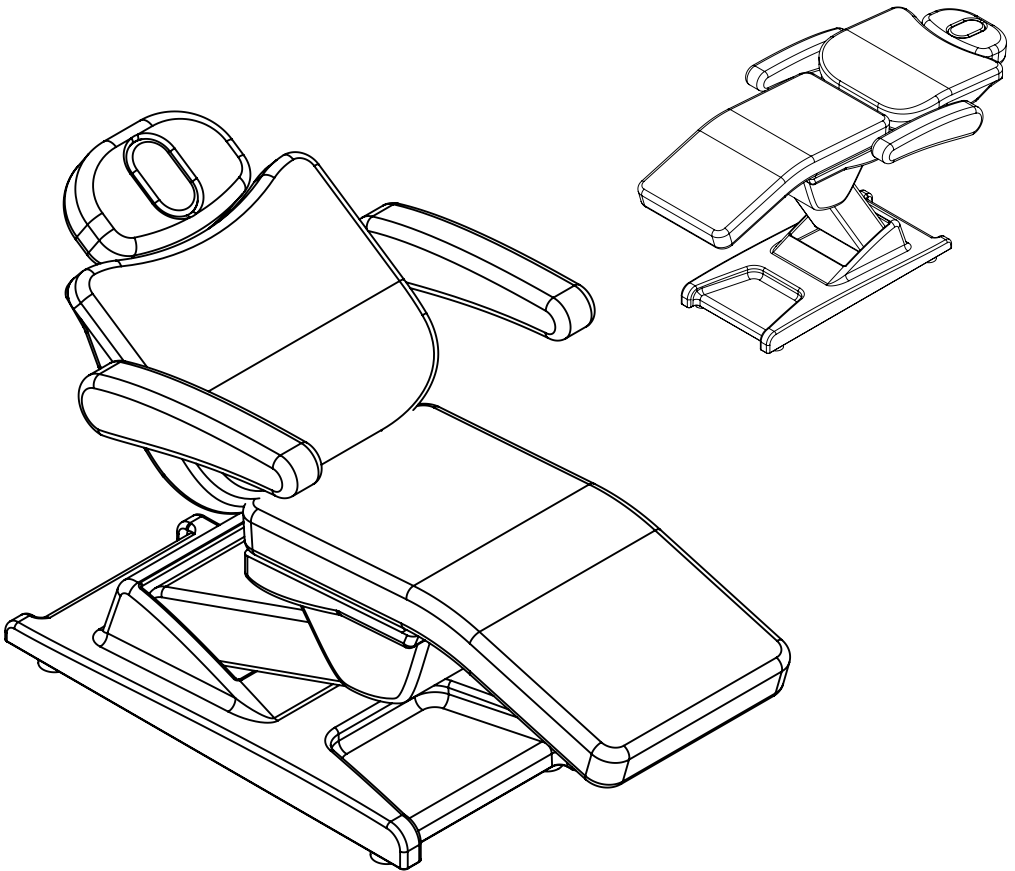



## IMPORTANT PLEASE READ THESE SAFETY INSTRUCTIONS

Listed below are essential safety precautions.

### GENERAL SAFETY

1. Read carefully and keep these instructions in a safe place.
2. Use this product only for its intended function and do not use attachments not recommended by the manufacturer.
3. Do not use outdoors.
4. Do not try to move the table when in use.

### ELECTRICAL APPLIANCES

1. All Power Points/Sockets must be installed by a qualified Electrician in accordance with local electrical standards.
2. DO NOT allow children to operate the electric motors in this product.
3. Turn the power off and remove the plug when not in use.
4. Turn the power off and remove the plug when cleaning.
5. Do not let the power cord get damaged in any way.
6. Keep the power cord away from heat sources.
7. Do not use an extension cord unless the cord complies with local electrical safety standards.
8. Periodically inspect the power cord for signs of damage.
9. Do not operate any electrical item with a damaged power cord.



### IMPORTANT

KEEP FINGERS AND HANDS AWAY FROM TABLE JOINTS UNDER THE TABLE



### IMPORTANT

DO NOT ALLOW CHILDREN AROUND THE TREATMENT TABLE WHEN IN USE



### IMPORTANT

DO NOT ALLOW CHILDREN TO OPERATE THE ELECTRIC MOTORS THAT MOVE THE TABLE



### IMPORTANT

DO NOT USE AROUND WATER OR IN A WET ENVIRONMENT



### IMPORTANT

WHEN REPLACING ANY PARTS OR ASSEMBLING THE TABLE, YOU MUST ENSURE THE TABLE IS RESTING ON ITS SIDE TO SAFEGUARD FROM CRUSH INJURY

## GET STARTED

### Venus Connect

#### Electric Treatment Table

- Electric height, back & tilt
- Hand held remote control
- Safety Certification:  
Medically approved Electric Motors
- Max Load: 200KG (440lbs)

#### FLAT POSITION

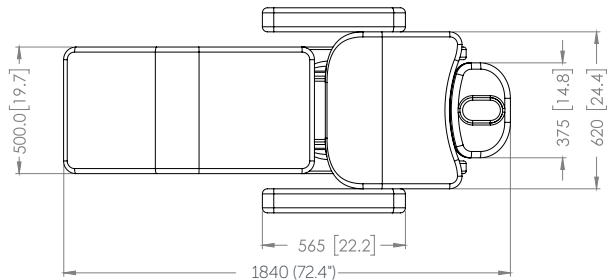

#### SEAT POSITION

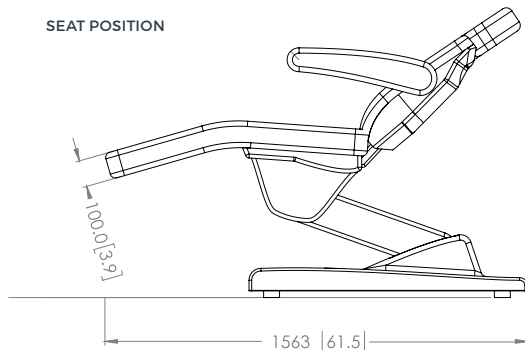

**LINAK**  
WE IMPROVE YOUR LIFE

#### OPTIONAL UPGRADE

BATTERY for back up power supply #6090

All measurements are in mm (inches).

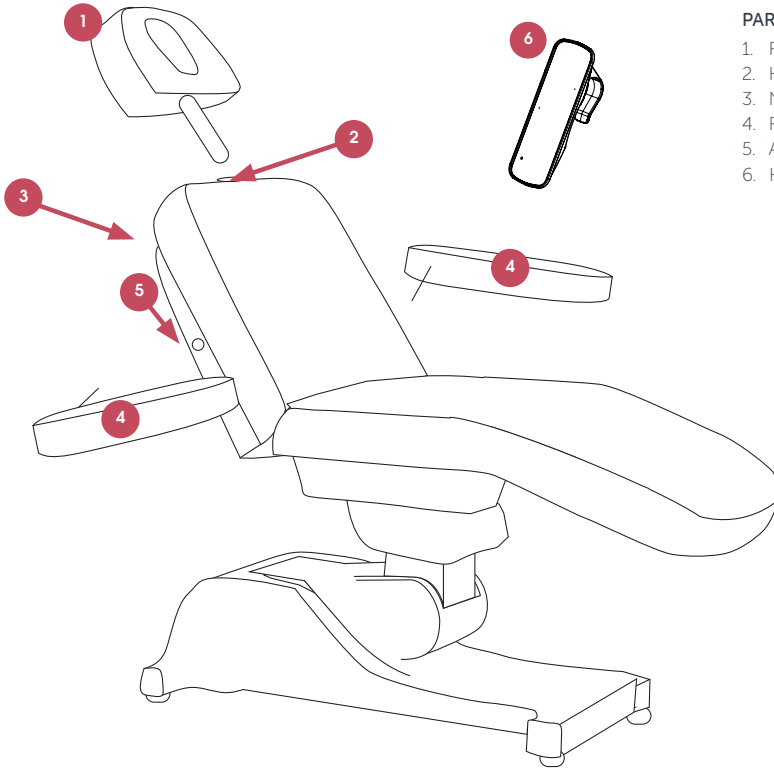

## PARTS

1. Removable headrest
2. Headrest Slot
3. Nut (at the rear of the chair)
4. Removable armrest
5. Armrest slot
6. Hand Held Bluetooth Remote

## ASSEMBLY

1. Slot the headrest pole into the slot provided (2) on the top of the chair. Tighten nut at the rear of the chair so headrest is secure (3).
2. Guide each armrest (4) with the pole/bolt into each slot (5) on the left and right of the chair. If the armrest does not lock flat in position, please swap arms over.

## INSTALLATION &amp; ASSEMBLY: BATTERY BACK UP

For a Step by step guide to install the Back Up Battery on your Gemini or Venus Electric Beauty Bed, refer to our Help & Support Website and watch the video:

Watch Video Here: <https://help.comfortel.com.au/solutions-troubleshooting/install-a-back-up-battery-on-a-treatment-table/>

## How to Install a Battery Back Up



Back up power supply available for our treatment tables. A step by step guide on how to install a battery on a Gemini or Venus Treatment Table.

Watch Video

**FUNCTIONS**

**BACK ADJUSTMENT**

Using the hand remote control, adjust the back adjustment by going up or down.

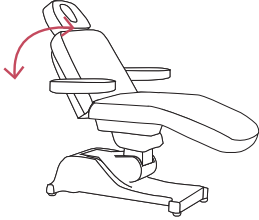

**HEIGHT ADJUSTMENT**

Using the hand remote control, adjust the table height by going up or down.

Minimum Height: 660mm

Maximum height: 890mm

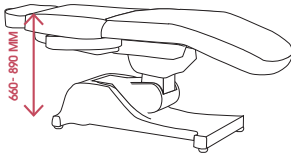

**TILT ADJUSTMENT**

Using the hand remote control, adjust the tilt of the bed by going forward and back.

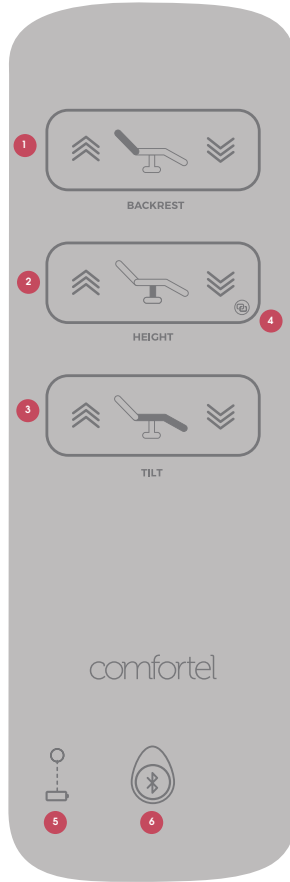
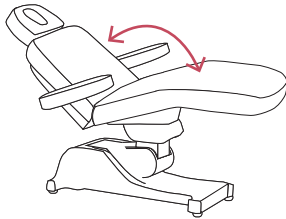

**HAND HELD BLUETOOTH REMOTE CONTROL**

1. Back Rest up/down
2. Height up/down
3. Tilt forward/back
4. Pairing mode
5. Battery Indication
6. Magnet pairing mode

**BATTERY INDICATION**

When the battery power level falls below 20%, the LED will flash 4 times when a key is pressed.

When the battery has been changed, the LED will be lit for 4 seconds after the first keypress.

**CHANGING THE BATTERY**

A standard CR2032 coin cell battery is required.

Open the battery cover on the back using a coin or a similar tool to turn the arrow counterclockwise from the locked state to the unlocked state.

**UPHOLSTERY**

All upholstery needs some care; good housekeeping will help to prolong the life of any upholstered products. Avoid extreme temperatures. Extreme cold can make your vinyl prone to cracking, while extreme heat can cause permanent stretching. Avoid exposing your products to direct sunlight for prolonged periods of time.

**ALWAYS FOLLOW THE CLEANING INSTRUCTIONS**

- Wipe with a clean colour fast cloth dampened with mild alkaline free soap and luke warm water. Do not wet excessively.
- Remove all traces of any cleaning product by wiping with fresh water and a clean cloth.
- Dry with a soft, clean cloth.
- Stubborn grime may require gentle scrubbing with a soft brush.

**Do not use:**

- hot or boiling water
- hydrocarbons including alcohol
- acetone
- furniture polishes
- bleach
- concentrated detergents
- abrasive powder or paste cleaners
- steel wool
- silicon or petroleum-based cleaners
- solvent based or abrasive cleaning agents

**MAINTENANCE**

A periodic inspection of all components and fasteners should be made to ensure that your Comfortel Product is structurally intact and functioning properly.

Damaged and broken parts should be replaced and loose fasteners tightened.

All maintenance to be carried out by a suitably qualified trades person.

 **IMPORTANT**

WHEN REPLACING ANY PARTS OR ASSEMBLING THE TABLE, YOU MUST ENSURE THE TABLE IS RESTING ON IT'S SIDE TO SAFEGUARD FROM CRUSH INJURY

# HELP & SUPPORT: ONE CONNECT APP

## ONECONNECT APP: SIMPLIFIED SUPPORT & TROUBLESHOOTING

Our OneConnect app is designed to provide you with streamlined support and troubleshooting.

Benefits of OneConnect:

- **Simplified Support:** Connect directly with our service technicians for quick issue identification and resolution. From help content to remote troubleshooting, our team is just a tap away.
- **Real-Time System Status:** Stay informed about your devices. View live status information, including troubleshooting needs, cleaning requirements, service alerts, and low battery notifications.
- **Bluetooth® Access System Data:** Wirelessly access usage history, feedback status, and diagnose problems in real-time with simple troubleshooting tools.
- **Remote Access System Data:** Retrieve system data from anywhere via the cloud. Check usage history, feedback status, and troubleshoot systems globally for optimized technical support.

With the OneConnect app, you'll enjoy simplified support and troubleshooting for your Comfortel Connect Series product.

Maximize its potential by leveraging the app's features and seamless connectivity with our service technicians.

Experience hassle-free technical support today!

### DOWNLOAD AND SETUP:

- **Download the App:** Visit the App Store or Google Play Store on your smartphone or tablet and search for "OneConnect." Download and install the app.
- **Create an Account:** Follow the in-app instructions to create a new account or log in if you already have one.
- **Pairing Devices:** Pair your Comfortel Connect Series product with the app by following the on-screen instructions and ensuring Bluetooth is enabled.
- **Explore Features:** Once paired, access system status, view data, and utilize support and troubleshooting resources within the app.



<https://onelink.to/w89ahn>

# comfortel

[help.comfortel.com.au](https://help.comfortel.com.au)

### PRODUCT CODE

#6032 VENUS TREATMENT TABLE

AU/NZ POWER: 240V, 50-60HZ, MAX 2.4A

UK/EU POWER: 240V, 50-60HZ, MAX 2.4A

US/CAN POWER: 110V, 50-60HZ, MAX 2.4A

MAX LOAD: 200KG (440lbs)

©Comfortel Furniture. All rights are reserved. No part of this document may be photocopied, reproduced or translated to another language without written consent of Comfortel Furniture Pty Ltd.

The information contained in this document is subject to change without notice and should not be construed as a commitment by Comfortel Furniture Pty Ltd.

Comfortel Furniture Pty Ltd. assumes no responsibility for any errors that may appear in this document nor does it make expressed or implied warranty of any kind with regard to this material, including, but not limited to, the implied warranties of merchantability and fitness for a particular purpose.

Comfortel Furniture Pty Ltd. shall not be liable for incidental or consequential damages in connection with or arising out of the use of this document and the program material.

**PLEASE RETAIN THIS INFORMATION FOR FUTURE REFERENCE**

### WARRANTY PERIOD

TERMS AND CONDITIONS. For more information about our warranty, please refer to our website:

WARRANTY



PURCHASE DATE

INVOICE NUMBER

NOTE YOUR PURCHASE DATE & INVOICE NUMBER FOR FUTURE REFERENCE