

PLUMBING: EURA TAPSET

#10153 EURA SHAMPOO BASIN TAPSET - GUN METAL STAINLESS STEEL

⚠ IMPORTANT
ALL PLUMBING MUST BE COMPLETED BY A LICENSED PLUMBER

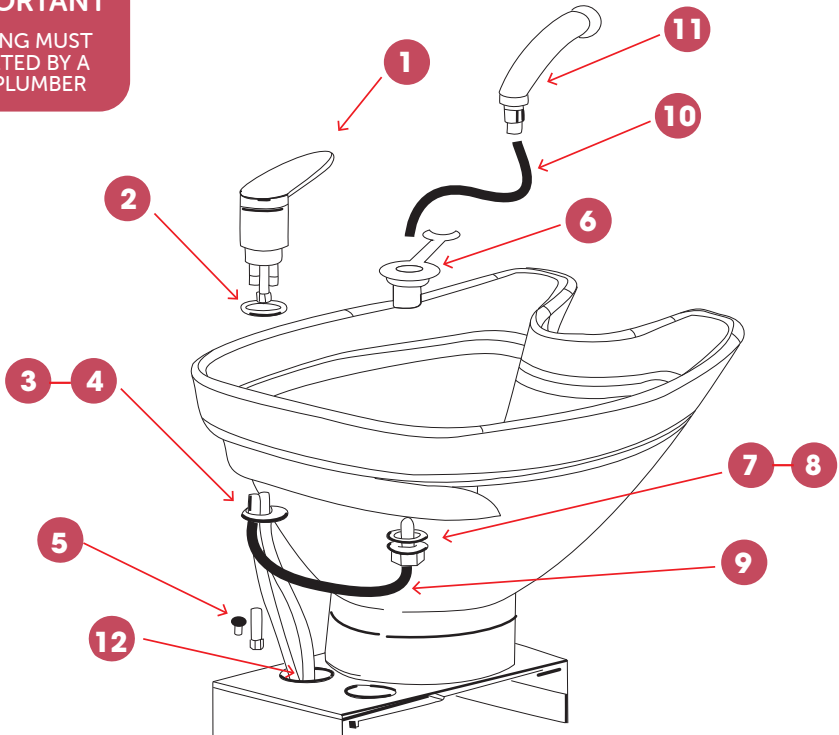

PARTS

- 1 Flick Mixer
- 2 O-ring
- 3 Plastic washers
- 4 Metal washers
- 5 Long nut
- 6 Showerhead cradel
- 7 Rubber washer
- 8 Washer & Nut
- 9 Mini Showerhose
- 10 Showerhead hose
- 11 Showerhead
- 12 Hot & cold braided hoses

EURA TAP SET & HOSE INSTALLATION

1. Install Flick Mixer (1) using O-ring (2), plastic and metal washers (3 & 4) & Long Nut (5) through the hole in the basin.
2. Install Showerhead cradel (6) in the basin hole using Rubber washer (7), Washer & Nut (8) through the other hole in the basin.
3. Connect both flick mixer and showerhead cradel with the mini showerhose (9).
4. Install Showerhead hose (10) to cradel and showerhead.
5. Connect hot and cold (1/2" connection) braided hoses (12) to flick mixer & respective supplies.
6. Continue to install plumbing as indicated in your product.



IMPORTANT PLEASE READ THESE SAFETY INSTRUCTIONS

GENERAL SAFETY

1. Read carefully and keep these instructions in a safe place.
2. Use this product only for its intended function and do not use attachments not recommended by the manufacturer.
3. Do not use outdoors.

PLUMBING

1. This unit must be plumbed by a licensed plumber.



IMPORTANT

ALL PLUMBING MUST BE COMPLETED BY A LICENSED PLUMBER



IMPORTANT

DO NOT ALLOW CHILDREN AROUND THE WASHLOUNGE WHEN IN USE

comfortel

help.comfortel.com.au

PRODUCT CODE

#10153 EURA SHAMPOO BASIN TAPSET
- GUN METAL STAINLESS STEEL

The information contained in this document is subject to change without notice and should not be construed as a commitment by Comfortel Furniture Pty Ltd.

Comfortel Furniture Pty Ltd. assumes no responsibility for any errors that may appear in this document nor does it make expressed or implied warranty of any kind with regard to this material, including, but not limited to, the implied warranties of merchantability and fitness for a particular purpose.

Comfortel Furniture Pty Ltd. shall not be liable for incidental or consequential damages in connection with or arising out of the use of this document and the program material.

©Comfortel Furniture. All rights are reserved. No part of this document may be photocopied, reproduced or translated to another language without written consent of Comfortel Furniture Pty Ltd.

PLEASE RETAIN THIS INFORMATION FOR FUTURE REFERENCE

For more information about our products and services, contact us at comfortel.com.au

WARRANTY PERIOD

TERMS AND CONDITIONS. For more information about our warranty, please refer to our website.

PURCHASE DATE

INVOICE NUMBER

NOTE YOUR PURCHASE DATE & INVOICE NUMBER FOR FUTURE REFERENCE