

# basin bench double

#10023 BASIN BENCH - DOUBLE

## RELATED PRODUCTS

#10010 BENCH KIT - WHITE BASIN

#10011 BENCH KIT - BLACK BASIN

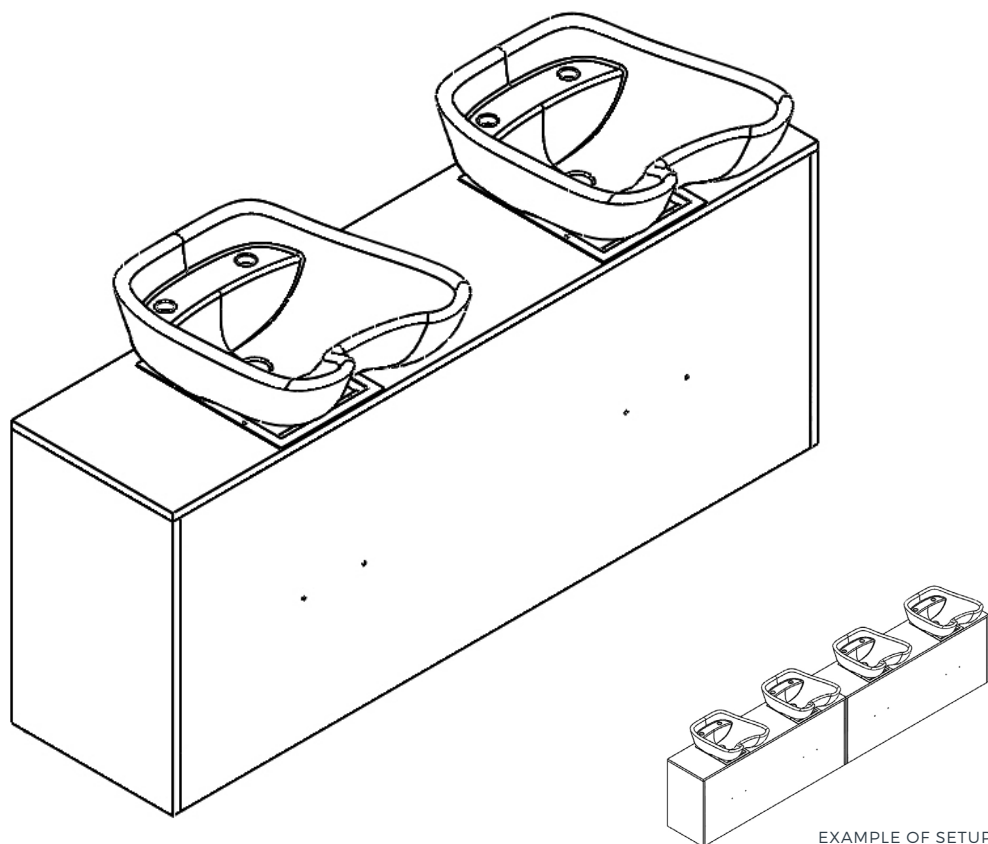



## IMPORTANT PLEASE READ THESE SAFETY INSTRUCTIONS

### GENERAL SAFETY

1. Read carefully and keep these instructions in a safe place.
2. Use this product only for its intended function and do not use attachments not recommended by the manufacturer.
3. Do not use outdoors.

### PLUMBING

1. This unit must be installed by a licensed plumber.



### IMPORTANT

**ALL PLUMBING MUST BE COMPLETED BY A LICENSED PLUMBER**



### IMPORTANT

**DO NOT ALLOW CHILDREN AROUND THE WASHLOUNGE WHEN IN USE**

## GET STARTED

### BASIN BENCH DOUBLE

Basin Bench can be used in situations requiring washing from behind.

**Width:** 1600mm

**Depth:** 400mm

**Bench Height:** 650mm

**Basin Height:** 900mm

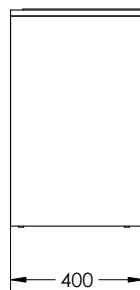
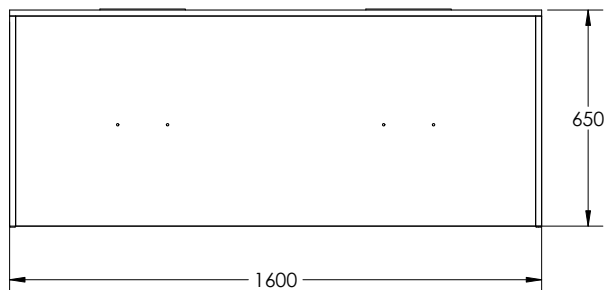

\*Basin not pictured

### BASIN BENCH DOUBLE

For a 4 Position Bench, please see 4 Position Diagram, where 2 x Basin Bench Doubles are installed next to each other. For more information about the product go to [www.comfortel.com.au](http://www.comfortel.com.au).

# POSITIONING : BASIN BENCH DOUBLE - 2 POSITION

AERIAL VIEW

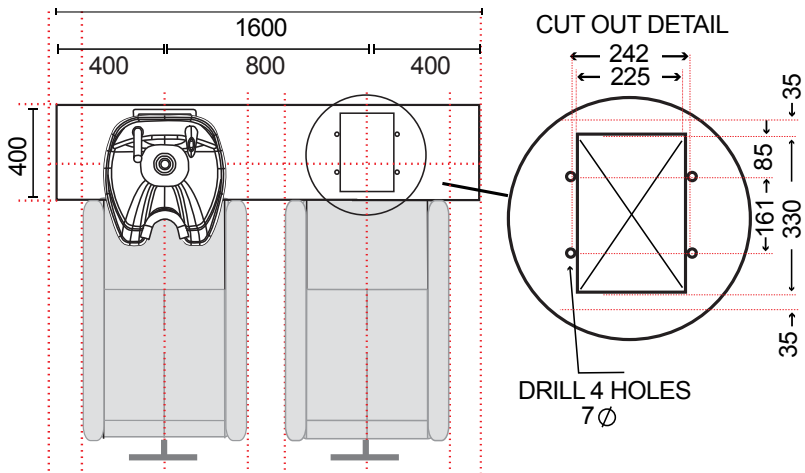

All measurements are in mm.

# POSITIONING : BASIN BENCH DOUBLE X 2 - 4 POSITION

AERIAL VIEW

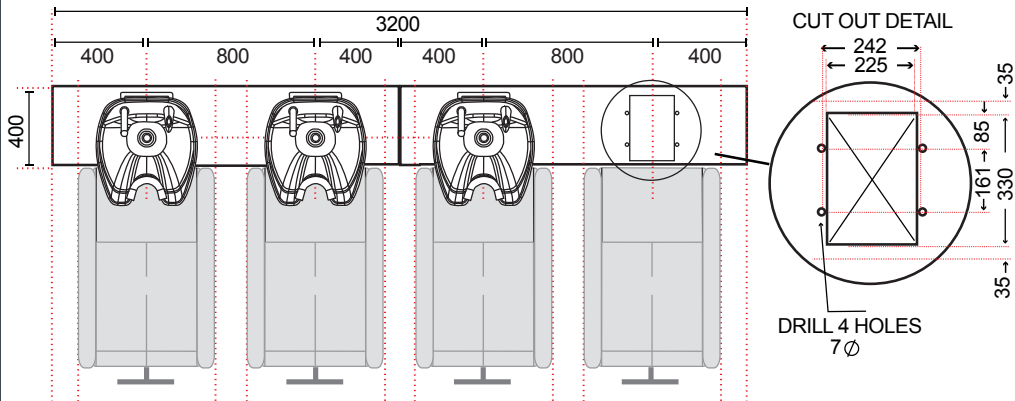

All measurements are in mm.

ASSEMBLY: BENCH

STEP 1

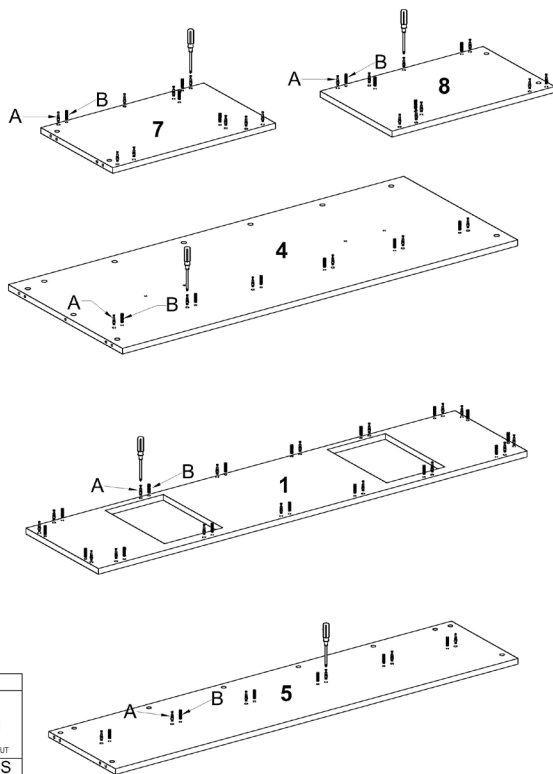
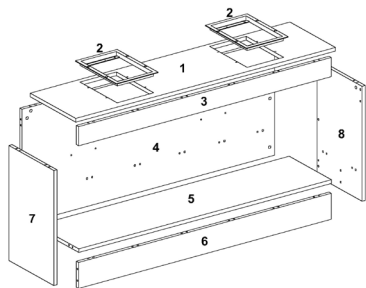

A	B	C	D	E	F	G
M6*25	Ø8*30	Ø15*14	M4*15	M6*20	Ø16/Ø6*2	W/LOCK NUT
46PCS	36PCS	46PCS	8PCS	8PCS	8PCS	8PCS

STEP 2

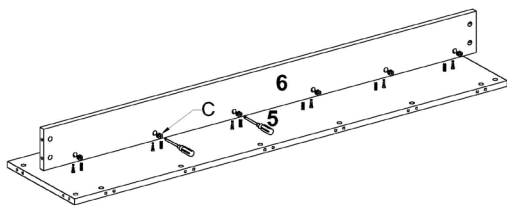

STEP 3

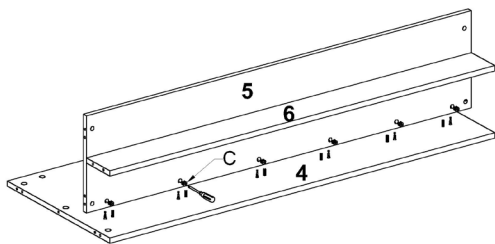

ASSEMBLY: BENCH

STEP 4

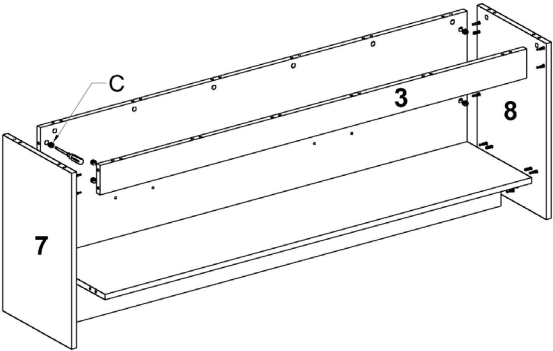

STEP 5

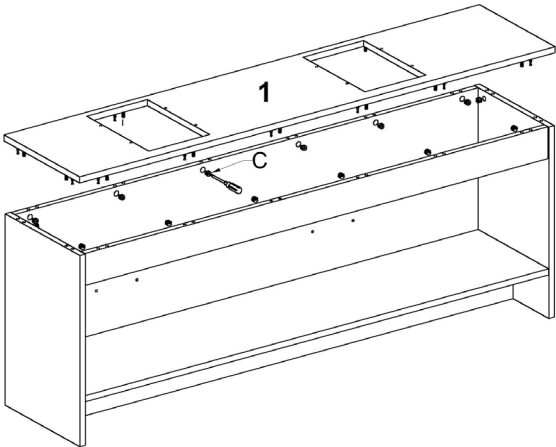

STEP 6

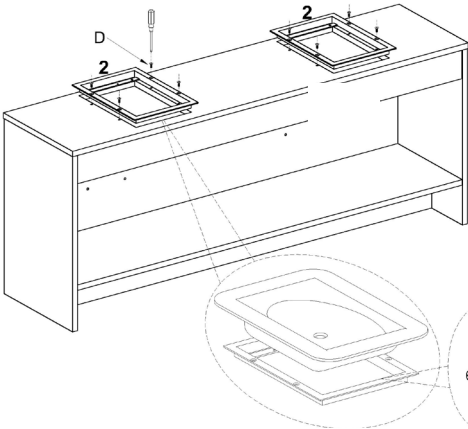

FINISH

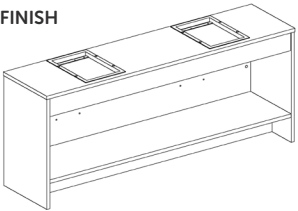

## INSTALLATION & ASSEMBLY: BASIN

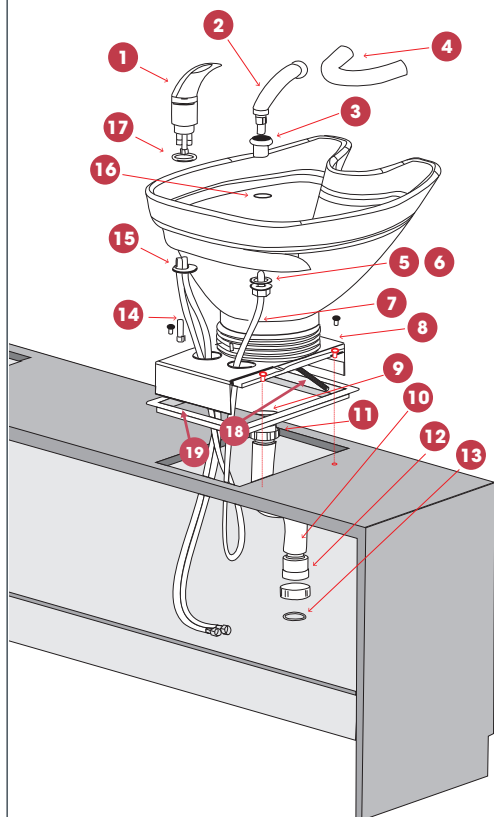

### BENCH FIXING DETAIL

1. Position Bench as required.
2. Bench must be secured to the floor, or wall.  
(Fasteners not provided)
3. Seal base – seal the base of the bench inside and outside with silicone.

### BASIN ASSEMBLY

4. Install Flick Mixer using the O-ring, plastic and metal washers & Long Nut, and Showerhead using the Showerhose Basin Collar, O-ring, Foam Washer and Plastic Nut as indicated.
5. Place Flick Mixer and Showerhead Hoses through the holes in the Vinyl Strap.
6. Connect Flexible Waste Pipe to Plug and Waste which is already installed making use of end with Flat Seal and fitted flange.

### BENCH KIT ASSEMBLY

7. Connect hot and cold (1/2" connection) water braided hoses to respective supplies.
8. Connect Flexible Waste Pipe (supplied) to P Trap (not supplied) making use of Seal and Flange.
9. Connect Basin Spring which is already connected to the tilt and slide plate to the hole in the Bench Kit Frame at the front left corner.
10. Place both ends of Vinyl Cover into the slots provided on front and back of Bench Kit Frame.

### BASIN ASSEMBLY

- |                           |                            |
|---------------------------|----------------------------|
| 1 Flick Mixer             | 11 Fitted flange           |
| 2 Showerhead              | 12 Flange                  |
| 3 Showerhose Basin Collar | 13 Seal                    |
| 4 Comfortneck             | 14 Long nut                |
| 5 Foam Washer             | 15 Plastic & Metal Washers |
| 6 Plastic Nut             | 16 O-ring                  |
| 7 Showerhead hose         | 17 O-ring                  |
| 8 Vinyl strap             | 18 Basin spring            |
| 9 Flat seal               | 19 Bench Kit Frame         |
| 10 Flexible Waste Pipe    |                            |



### IMPORTANT

ALL PLUMBING MUST BE COMPLETED  
BY A LICENSED PLUMBER

## INSTALLATION & ASSEMBLY: OPTIONAL CHAIR TO BASIN BENCH

### 28 Connector

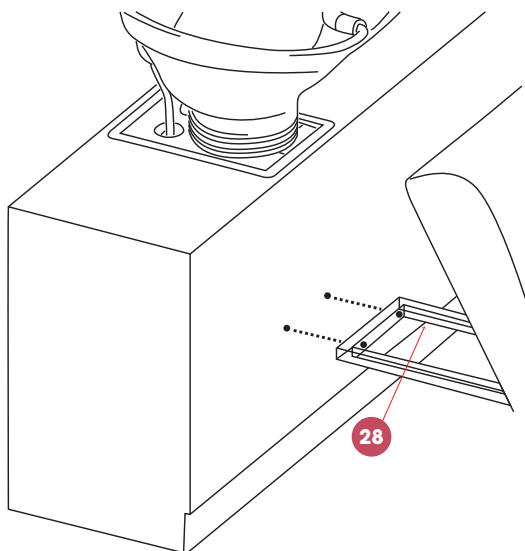

### INSTALL CHAIR TO BASIN BENCH

- Fix Connector to Bench front using two bolts and nuts provided. Refer to sketch for drilling details.
- It is recommended to install these brackets before installing bench for easy access.

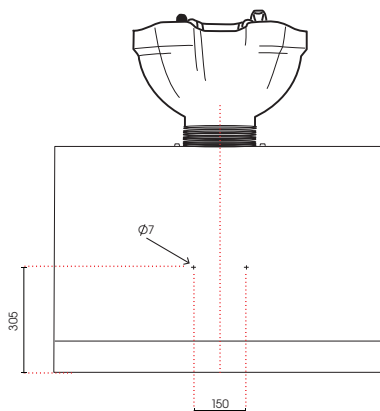

## MAINTENANCE

A periodic inspection of all components and fasteners should be made to ensure that your Comfortel Product is structurally intact and functioning properly.

Damaged and broken parts should be replaced and loose fasteners tightened.

All maintenance to be carried out by a suitably qualified tradesperson.

### HOW TO CHANGE A SHOWERHEAD

Please view our online video on how to change a showerhead:

[www.youtube.com/user/Comfortel](http://www.youtube.com/user/Comfortel)

## CLEANING

### BENCH

For cleaning the surfaces:

- Wipe using a soft, damp cloth moistened with warm soapy water
- Dry with clean soft cloth (never use abrasive cleaners)

#### Do not use:

- |             |                      |              |
|-------------|----------------------|--------------|
| • acetone   | • furniture polishes | • bleach     |
| • detergent | • abrasive cleaners  | • steel wool |

### UPHOLSTERY

- All upholstery needs some care; good housekeeping will help to prolong the life of any upholstered products.
- Avoid extreme temperatures. Extreme cold can make your vinyl prone to cracking, while extreme heat can cause permanent stretching.
- Avoid exposing to direct sunlight for prolonged periods of time.

### ALWAYS FOLLOW THE CLEANING INSTRUCTIONS

- Clean regularly (weekly) to remove body oils which cause hardening
- To clean use a sponge which has been moistened in warm soapy water
- After cleaning with a sponge, dry with a soft, clean cloth
- Stubborn grime may require gentle scrubbing with a soft brush

#### Do not use:

- |             |                      |              |
|-------------|----------------------|--------------|
| • acetone   | • furniture polishes | • bleach     |
| • detergent | • abrasive cleaners  | • steel wool |

Damage caused by any improper treatment of this product is not covered by the product warranty



help.comfortel.com.au

PRODUCT CODE

- #10023 BASIN BENCH - DOUBLE
- RELATED PRODUCTS
- #10010 BENCH KIT - WHITE BASIN
- #10011 BENCH KIT- BLACK BASIN

Revision Date: 28.06.2018

©Comfortel Furniture 1997-2018. All rights are reserved.  
No part of this document may be photocopied,  
reproduced or translated to another language without  
written consent of Comfortel Furniture Pty Ltd.

The information contained in this document is subject to change without notice and should not be construed as a commitment by Comfortel Furniture Pty Ltd.

Comfortel Furniture Pty Ltd. assumes no responsibility for any errors that may appear in this document nor does it make expressed or implied warranty of any kind with regard to this material, including, but not limited to, the implied warranties of merchantability and fitness for a particular purpose.

Comfortel Furniture Pty Ltd. shall not be liable for incidental or consequential damages in connection with or arising out of the use of this document and the program material.

**PLEASE RETAIN THIS INFORMATION FOR FUTURE REFERENCE**

For more information about our products and services, contact us at [comfortel.com.au](http://comfortel.com.au)

WARRANTY PERIOD

TERMS AND CONDITIONS. For more information about our warranty, please refer to our website.

INVOICE NUMBER

NOTE YOUR PURCHASE DATE & INVOICE NUMBER FOR FUTURE REFERENCE